

## Getting connected to Yes 4G

1. With your computer Wi-Fi turned on, view the list of available wireless (Wi-Fi) networks.
2. Select from this list the network named “Yes, you are amazing -000XXX” where XXX are the last digits of your device’s MAC address, listed on the label under the battery.
3. To configure your Huddle, type `http://192.168.1.1` into the address bar of your web browser while connected to the Huddle via Wi-Fi.
  - The default username/password of the device is “admin”

4. Proceed to “Basic Setup”, follow the on-screen setup wizard.

Step 1:

Input your Yes ID / password

Step 2:

Change your WiFi network name and secure it with password

Step 3:

Summary of changes, then proceed with clicking Save

5. Power off the Huddle.

6. Power on the Huddle, the Huddle will then attempt to connect to the Yes 4G network. The LED indicator will turn solid green, yellow or red to indicate either strong, moderate or weak signal.

7. Congratulations! You are now connected to the Yes 4G network.

For future administration, bookmark the device homepage, `http://192.168.1.1` for easy access.



**Huddle with friends  
and family to share  
the Internet at home,  
at the park, at the  
café, in a car...**

## Items inside the box



Yes Huddle  
Portable 4G Hotspot



Wall  
Charger

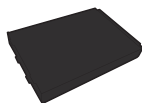

Battery  
Pack



USB  
Cable

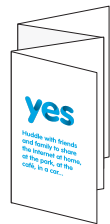

Quick  
Start  
Guide

## Huddle

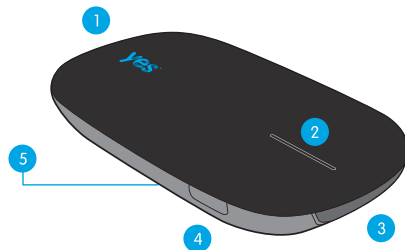

- 1 USB Port: For battery charging and/ or tethered operation
- 2 4G signal status LED (Red, Yellow, Green) and WiFi status LED (Blue)
- 3 Ventilation panel
- 4 Power button and battery status LED
- 5 Battery cover

## Insert Battery & Connect for charging

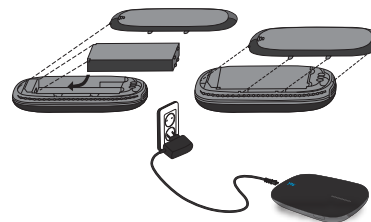

1. Plug the USB cable into the Huddle and connect the adaptor to the electrical outlet. The power icon on the Huddle will be illuminated red, indicating the battery is charging.
2. The power button will turn green when the battery is fully charged.
3. Once fully charged, turn the Huddle on by holding the power button for 2-3 seconds.
4. After powering on, your Huddle will search for a 4G signal automatically. While attempting to connect, the LED indicator will flash red.

**Note:** The Huddle can be charged using the provided USB cable with your computer's USB port.

## More information

Device features and time-saving tips  
[www.yes.my/store](http://www.yes.my/store)

Terms & conditions and warranty statement  
[www.yes.my/product-inc](http://www.yes.my/product-inc)

Technical support  
[www.yes.my/support](http://www.yes.my/support) or  
email [yescare@yes.my](mailto:yescare@yes.my)